

➤ Thank you for choosing **SurgiTel®**!

Your SurgiTel® LED headlight has been designed to meet the demanding needs of today’s clinical professionals by allowing you to see, work, and feel your best.

➤ TECHNICAL DATA

LED Light	Mini or Micro optic
Battery Charge Life (with 3 batteries)	Up to 4 hours (about 1 hour and 20 minutes per battery)
Battery	Rechargeable Lithium Ion Battery, 3.7V 350 mAh
Battery Charger (cradle) & AC Power Adapter	Input: 100-240V, 50-60Hz, 0.35A Output: 5V \equiv 200mA

➤ GENERAL WARNINGS

- The user of this product should be thoroughly familiar with the use and care of this product.
- The user should carefully study the manual before making any attempt to use this product clinically.
- Before each procedure carefully inspect the LED system to ensure proper maintenance.
- Use care to not point the light directly at the eyes during operation; patient use of safety glasses is recommended.

FIRE HAZARD: DO NOT PLACE THE LED LIGHT UNIT ON ANY FLAMMABLE OBJECT WHILE IT IS OPERATING.

WARNING:

- The LED light unit will get hot when left on. Handle with care. It is recommended to turn off the LED before handling LED light or making any adjustments to it.
- Avoid direct light contact with the eyes.
- Avoid direct light irradiation in patient’s eyes; patient use of safety glasses is recommended.

Battery Charger (cradle) and AC Power Adapter

- Use only the Battery Charger and AC Power Adapter supplied with this system.
- Do not disassemble, modify or short circuit.
- Do not leave in hot places, such as inside a car or outside in hot weather.
- Do not allow to get wet.

➤ WARRANTY

SurgiTel’s mission is to provide the best products for your *Vision and Ergonomics at Work*. To support this commitment SurgiTel® warranties all of its products.

SurgiTel® strives to make the best loupes and light systems available. Please inspect and try on product immediately upon receipt. If you notice any issues, contact our customer service department at 800-959-0153.

For both warranty and out-of-warranty issues, contact SurgiTel® Customer Service regarding repairs.

Warranties vary by product. Check www.surgitel.com/warranty for more details. Check www.surgitel.com/help for up to date care information/instructions. Please keep up to date on care information/instructions, as warranties can be affected if the product is misused.

➤ PATENT

True color beam family optics, U.S. Patent Numbers: US 9,383,077 B2; US 9,494,299 B2

SurgiTel

A Division of General Scientific Corporation
77 Enterprise Drive • Ann Arbor, MI 48103-9503
E-mail support@surgitel.com • www.surgitel.com

SurgiTel®



Wireless Air LED

USER INSTRUCTIONS

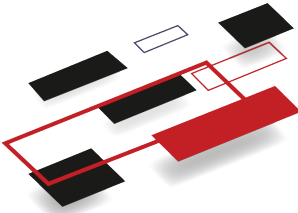

➤ CLASSIFICATION

- Protection against electric shock: Class II including AC/DC Adapter.
- Applied parts: No applied parts.
- Protection against harmful ingress of water: ordinary IPXO.

	Direct current		Class II equipment
	CE mark		Serial No.
	Alternating current		Attention, consult accompanying documents

➤ MAINTENANCE

Storing the LED system in a safe place will prolong the life of the unit. The following guidelines will help in sustaining the LED systems useful life:

- Keep the optical face on the light unit from touching hard surfaces which may cause scratches on the surface. Scratches on the surface will diminish the light quality.

Fixing Hinge Tension (too loose or too tight):

- Step 1: Use provided hex key to remove hinge set screw (see photo to the right).
- Step 2: Use two flat-head screwdrivers (placed on each side) to loosen/tighten special screw and nut.
- Step 3: Once desired tension is met, reassemble and tighten set screw.

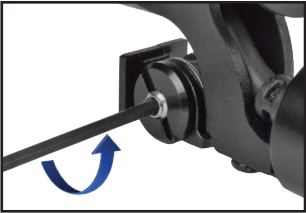

➤ CLEANING & DISINFECTING

Cleaning
To clean your SurgiTel LED headlight, wipe down with a damp cloth using room-temperature water. Carefully wipe with a damp cloth avoiding the open slots located on the light unit.

Disinfecting
Clean LED headlight before disinfecting. Visit www.surgitel.com/help for the most current recommended disinfectants. To disinfect your LED headlight, make sure to wring out the disinfecting cloth to remove any excess moisture.

DO NOT
Immerse LED headlight in water or any liquid, use hot or cold water, avoid using running water on or near the open slots located on the light unit. Doing so will void the warranty.

DO NOT USE
Any disinfectant sprays on or near open slots located on the light unit. Do not immerse LED headlight in any liquid. Do not use any disinfectants containing alcohol, hydrogen peroxide, ethanol, ammonia, glutaraldehyde, iodophors, bleach, acid, phenol, acetone, or products that have not been approved for use by SurgiTel. Do not use an autoclave. Doing so will void the warranty.

FACTORY REFURBISHMENT CLEANING: is available if you come across a difficult cleaning situation. Call customer support for details: 800-959-0153

➤ OPERATION



HOW TO TURN LIGHT ON AND OFF

Touch on/off symbol (B) on control panel to turn light on or off. When light unit is turned on, a red indicator light (A) will appear.

BRIGHTNESS OF LIGHT

Brightness of light is nonadjustable and is factory set at max brightness.

Note about light-cured composites

- Using the appropriate COLOR FILTER (orange filter) is STRONGLY RECOMMENDED when using light-cured materials with the LED Light.

➤ OPERATING CONDITION

- Ambient temperature range 10 to 40°C
- Relative humidity range 30 to 75%
- Atmospheric pressure range 70 to 106 kPa

➤ TRANSPORT & STORAGE CONDITION

- Ambient temperature range -40 to 70°C
- Relative humidity range 10 to 100%
- Atmospheric pressure range 50 to 106 kPa

➤ ATTACHING LIGHT ADAPTER TO LOUPE



Dove Tail Adapter



Clip Adapter (provided w/ kit)

- Attach the LED light to loupes or glasses using appropriate adapter

➤ ADJUSTMENTS

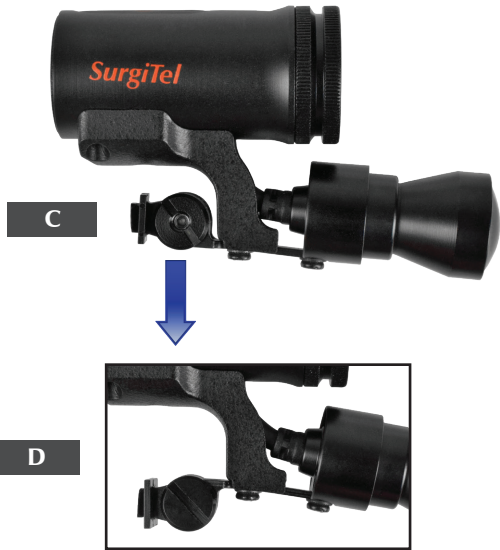

Vertical Alignment (C):

Maximum range of adjustment for light system placement.

Optional Light Adapter Assembly (D):

Recommended option if experiencing attachment difficulties or alignment issues with loupe, remove screws and reassemble by changing the light adapter position (as shown).

➤ RECHARGEABLE BATTERIES

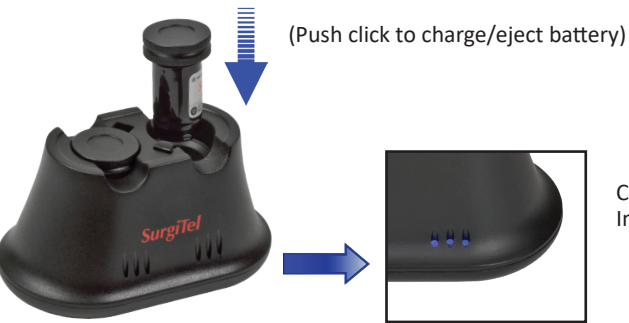

Charge Level Indicator

- Charge Time = approximately 1 hour
 - Charge Level Indicator Lights (3 qty., color: blue): All 3 lights on = fully charged
 - Maximum continuous operation (1 battery) from full power is approximately 1 hour and 20 minutes.
- Note: To maximize use of Wireless LED Air, remember to replace and charge battery after use.